



Access the NATCA Constitution, Robert's Rules of Order, and Proposed Amendments and Resolutions via the NATCA Convention e-Book. These documents can be viewed on a smartphone, tablet, or computer. Users will be able to search, record notes, or jump to specific pages. To download the document, scan the QR code at left. Download information for the Convention app can be found on page 12.



For inclusion in the afternoon's business, resolutions and untimely amendments must be submitted, in writing, by 11:30 a.m. of the day on which they can be heard. Submissions can be made via e-form on the NATCA Convention website, emailed to resolutions@natcadc.org (must contain name, facility, region, email, cell phone, text of resolution, date, & time), or in writing to the EVP using the printed submission form. **Electronic submissions preferred; scan QR code at left to submit via email.**

The Delegate



PUBLISHED DAILY FOR NATCA'S 15TH BIENNIAL CONVENTION

THURSDAY • OCTOBER 2, 2014



President Rinaldi Tasks Delegates to 'Move from Good to Great'

After a stirring National Anthem and labor song performed by the band the Street Dogs, NATCA President Paul Rinaldi took the stage Wednesday morning to welcome the delegates to the 15th Biennial Convention in Minneapolis.

Speaking to a room full of first-time convention attendees and delegates, Rinaldi explained, "You are here to take the pulse and set the course for NATCA."

"Brothers and Sisters, we are the best we have ever been! And I am so proud of this Union. We have learned from the past, and we are building for the future," Rinaldi said. "We have changed the way people think of us. Internal and external. We have taken on the forces of conventional wisdom. We have challenged the system, and the status quo. We are turning the ship of establishment thinking."

Rinaldi cautioned that however strong the Union is, there is always need for improvement and no room for ambivalence. "Those who think we are good enough will prevent us from becoming great. Good is the enemy of great. I don't want to settle for good. I want this Union to be great."

Greatness, Rinaldi remarked, takes on a whole new meaning considering the events that took place last Friday at Chicago Center (ZAU). He commented that this past Tuesday, Chicago O'Hare International Airport was the busiest airport in the National Airspace System (NAS), despite the fire in the Center that crippled the NAS and brought ZAU to ATC-0 just days before.

It is important to remember, Rinaldi urged, that our Union's challenges extend beyond



NATCA President Paul Rinaldi opens the 2014 NATCA Convention.

DAY 1: VOTES ON DUES, CONVENTION FREQUENCY

The 15th Biennial Convention business session began just before 1:30 p.m. on Wednesday afternoon with President Paul Rinaldi chairing. Grace Colby, Executive Support Specialist, Marguerite Graf, General Counsel, Elisa Muise, Constitution Committee Member, Jim Slaughter, Parliamentarian, and Trish Gilbert, Executive Vice President rounded out the dais.

Before voting on resolutions, several committee chairmen made their reports. Credentials Committee Chair Chris Boughn announced 368 delegates were present, and Ed Szczuka delivered the Finance Committee report. Rules Committee Chair Heath Wilson briefed the delegation on the Convention Rules before any discussion or voting began. Wilson also noted the absence of President Emeritus Barry Krasner and thanked him for all of his help.

"You are dearly missed at this Convention," he said, echoing the thoughts of many of the delegates.

Renae Hultgren gave the report of the Constitution Committee, urging FacReps to turn in their local constitutions. The Committee is about to begin auditing those constitutions and ensuring they are updated and in line with the National Constitution and any laws and regulations. Hultgren also noted the absence of Barry's wife and NATCA's Office Manager, Sallie Sullivan. "I appreciate all the help Sallie has given me at the National Office. Even when she was packing up her house in New York, she still responded to requests within an hour. We're missing you here, Sallie."

Rinaldi then began official business by proceeding with a vote on the Convention Rules. An amendment to the Committee's

continued on page 6

continued on page 3

AGENDA

WEDNESDAY



Street Dogs perform the national anthem.



NGL RVP Bryan Zilonis introduces the 2014 Minneapolis Convention Committee.



N90 FacRep Dean Iacopelli and N90 members present the Krasner Award to Phil Barbarello.



Convention business gets underway.



Convention attendees are "All In for NATCA."

THURSDAY



7:30 AM - 5:30 PM

REGISTRATION

Minneapolis Ballroom Foyer

8:00 AM - 5:00 PM

EXHIBITS / NCF AUCTION

Minneapolis Ballroom Foyer

8:30 AM - 5:30 PM

GENERAL SESSION

Minneapolis Ballroom

12:25 PM - 1:25 PM

LUNCH WORKSHOPS

- Arrested Development.....Conrad A
- OSHA Awareness.....Conrad D
- Your Traffic, Your Complexity,
Your PayMarquette II & III
- Presenting Greatness.....Marquette IV & V
- Communications & Social Media ...Marquette VI
- Key NATCA Arbitrations (Part II)
& Witness Selection/Prep.....Marquette VII
- Building a Stronger LocalMarquette VIII & IX
- NATCA SafetySymphony I & II

6:30 PM

REGIONAL DINNERS

- Alaskan
- Central
- New England
- Northwest Mountain
- Region X The Pourhouse
- Eastern
- Southern
- Southwest..... The News Room
- Great Lakes..... Cowboy Jack's
- Western Pacific Hell's Kitchen

FRIDAY



7:30 AM - 8:00 AM

MORNING WORKSHOPS

- Local Organizing..... Marquette II
- Communications & Social Media Marquette III
- PAC Advocacy Marquette IV
- Local Union Officer Elections..... Marquette VIII & IX

7:30 AM - 5:30 PM

REGISTRATION

Minneapolis Ballroom Foyer

8:00 AM - 5:00 PM

EXHIBITS

Minneapolis Ballroom Foyer

8:30 AM - 12:30 PM

GENERAL SESSION

Minneapolis Ballroom

12:30 PM - 2:10 PM

AWARDS LUNCH

Minneapolis Ballroom

2:10 PM - 5:30 PM

GENERAL SESSION

Minneapolis Ballroom

6:00 PM

CLOSING BANQUET

Nicollet Island Pavilion

SHULER PRAISES UNION, RELOADED



“

“When air traffic controllers were in the political crosshairs, you didn’t hang your heads. You didn’t buckle under sequestration, or give up over the reckless congressional budget brinkmanship. You acted. And you produced results. And you do that time and time again.”

“We know that a union contract is the best route to good jobs with decent pay, benefits, and security. The problem is only seven percent of millennials have a union on the job. That’s a real disconnect. Young workers need unions. And unions need young workers at least as much. We know that if we don’t engage, organize, and develop young workers, the future of our entire movement is at risk.”

”

“

“America needs stable funding for our aviation infrastructure. We need safe, efficient systems. We have to continue modernizing the air traffic system with new equipment and new procedures. But that can only be done with stable funding. It takes political leaders.”

INTERNATIONAL ATC UNIONS: IN THE WORKPLACE

The combined effect of sequestration in the spring of 2013 and the government shutdown in October 2013 created a tremendously negative and uncertain situation for NATCA members, other FAA employees, and air travelers, who suffered through needless flight disruptions for one chaotic week in April 2013.

Sequestration spurred NATCA to actively engage in an important discussion on the future of how to fund the National Airspace System and move away from the fiscal instability that has become the norm on Capitol Hill. That discussion continues today with a panel of air traffic control leaders from around the world. They will provide perspectives on the effect that different funding structures have had on their controllers and what NATCA members can learn from them. They will also discuss their day-to-day experiences in their respective workplaces.

NATCA Executive Vice President Trish Gilbert will moderate this panel, which includes Canadian Air Traffic Control Association President Peter Duffey, Civil Air Australia President Daryl Hickey, International Federation of Air Traffic Controllers’ Associations President Patrik Peters, and Paul Winstanley, the Chair of the United

Kingdom’s Air Traffic Control Branch of Prospect, the union representing U.K. controllers.

NATCA’s position on funding has been clear: NATCA does not support privatization of our nation’s ATC system. But it does support active discussions regarding how to ensure the system’s financial stability. The entire U.S. aviation community is now in agreement that something needs to change. The safety and efficiency of air traffic should not hang in the balance of budget squabbles on Capitol Hill. While there is no consensus on what the solution is, there is real urgency, and that is encouraging.

At Communicating for Safety 2014, Winstanley and Hickey participated in a panel discussion that helped NATCA members to understand the relationships between labor and management in the U.K., Australia, and Canada – countries with distinctly different funding structures than that of the U.S. Today’s discussion will delve a bit further and give delegates insight into their international colleagues’ day-to-day working conditions.

DAY 1 continued from page 1

proposed Rules failed and the Rules as proposed were adopted.

Rinaldi then moved forward with the first resolution, R14-01, Proposed Name Change for RNAV (Retired NATCA Active Volunteers).

Elaine Poe, RNAV Chair, urged the delegation to oppose the resolution. She said RNAV was created after the Area Navigation technology that shares the acronym and felt as though the proposed name was not strong enough for the committee.

“I urge the supreme body to defeat it,” she said. After voting, the resolution failed and the RNAV name remained.

The second resolution, R14-02, Annual Membership Dues, was also previously moved and seconded by the NEB. After little discussion, Eastern Region ARVP and N90 FacRep Dean Iacopelli motioned to end debate on the resolution. After no objections were heard, a roll call began.

Each delegate then cast the votes for their facility as apportioned: 14,283 total votes were cast, 13,321 affirmative, and 962 negative. It was a resounding 93% affirmative vote on adopting the National Executive Board’s plan for stabilizing NATCA’s dues structure.

The remaining resolutions each passed with little to no debate. R14-11 Contracting Facilities was postponed until tomorrow after the International Panel has made its presentation.

Rinaldi moved on to the proposed Constitutional amendments, postponing several until after discussions and a panel take place tomorrow. A14-09 sparked much discussion among the delegates. The amendment, which was proposed

by the National Executive Board, proposed holding Convention every three years, rather than every two years as presently required.

Beginning the discussion was Great Lakes Regional Vice President Bryan Zilonis. He said one of the reasons for supporting the amendment was to save money. “With a specific goal to save money, there is no way to really change the expense of the Convention.” The only way to reduce expenses was to reduce the frequency of Conventions.

John Paiva, a member from Brackett Field ATCT (POC) encouraged the delegation to oppose the amendment, citing the timeliness of the dues restructuring resolution.

“The well-being of the Union has to come first, and part of that is coming together every two years,” he said. “Every two years is needed for the strength of the Union.”

Los Angeles Center (ZLA) FacRep Nate Pair also urged the delegation to oppose the amendment, arguing that there was too large of an experience gap between new and experienced members to let three years pass between Conventions.

“For half of the room, this was the first time they have been to Convention,” he said. “In six or eight years down the line, we may be able to move to a three-year Convention when the membership has changed and the turnover has taken place.”

The delegation concluded that it was not in the best interest of NATCA to change the two-year Convention cycle and A14-09 failed.

ZAU RISES ABOVE, AREA FACILITIES KEEP SKIES SAFE

In the early morning hours on Friday, Sept. 26, a fire in the basement of Chicago Center (ZAU) shut down one of the nation's busiest en route centers and brought the airspace above the Midwest to a screeching halt. ZAU declared ATC-0 and grounded hundreds of flights. By Saturday, nearly 850 flights had been canceled, and more than 1,700 were severely delayed.

Chicago-area controllers' quick reflexes and expert maneuvering safeguarded the wellbeing of passengers not only in the immediate vicinity, but that of travelers en route to destinations all over the country and Canada, including NATCA staff and members flying into nearby Minneapolis to prepare for Convention.

"This is one of the most challenging situations that air traffic controllers and other FAA employees have faced since 9/11," said NATCA President Paul Rinaldi. He was luckily able to rebook his flight in order to make it to Minneapolis in time for NEB meetings the next day. "The damage to this critical facility is unlike anything we have seen before. Since the first moment when radarscopes went dark at Chicago Center Friday morning, controllers have ensured the highest level of safety at all times. We know this has been a tremendous disruption to the travel plans of many people. We are working diligently to re-establish as close to normal operations as possible to minimize the inconvenience to travelers while keeping safety above everything else."

There are four en route centers that border the ZAU airspace: Cleveland Center (ZOB), Indianapolis Center (ZID), Kansas City Center (ZKC), and Minneapolis Center (ZMP). Each of these facilities has taken on ZAU airspace responsibilities,



Controllers at work in Chicago Center's temporary command center.

and have worked very well with the Command Center in Herndon, Va., TRACONS in Chicago, Milwaukee, Fort Wayne, South Bend, and elsewhere, as well as with many control towers, including both O'Hare and Midway Airports in Chicago.

"We have seen a plan of action established by the adjacent centers and other key facilities that is evolving and improving by the hour, and providing safe service that is increasing in efficiency," NATCA Executive Vice President Trish Gilbert said shortly after the incident occurred. "Air traffic controllers are trained to expect the unexpected and make a new plan work safely. The level of resourcefulness

continued on page 9

SPOTLIGHT: MINNESOTA FACILITIES

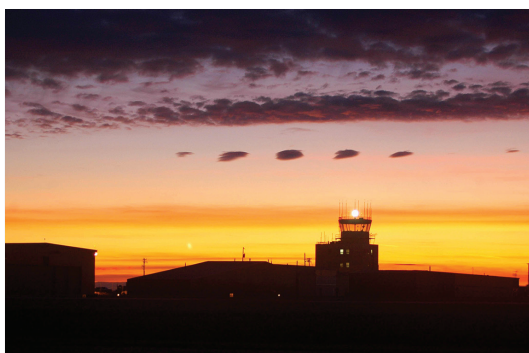

FCM FLYING CLOUD ATCT

This 100 percent NATCA facility is located approximately 11 miles southwest of downtown Minneapolis. Flying Cloud Airport (FCM) services many different types of aircraft ranging from the C152 to the G5.

Every July, FCM hosts Air Expo, an aviation event that features a wide variety of vintage airplanes. This fun and history-filled weekend attracts a large crowd. During this event, the FCM local hosts an open house and barbeque that encourages local pilots to spend time with the controllers.

"Our facility is a friendly facility," says FacRep Wes Wiest. "The best part of being the FacRep is working to make our facility even better than it already is."



RST ROCHESTER ATCT

Rochester International Airport (RST) is a 100 percent NATCA facility! The 17 controllers work mainly small general aviation aircraft, corporate jets, regional jets, and military C-130s.

The city of Rochester is home to the Mayo Clinic, recently named the best overall hospital in the country, which also brings in a lot of Medevac aircraft.

Outside of work, RST controllers come together for solidarity events including holiday parties and barbeques.

"The best part of being the FacRep is constantly trying to improve the overall work experience for all the controllers here," says RST FacRep Ben Madsen. "If you keep making small improvements here and there, there is always something in the short term to look forward to."



STP ST. PAUL ATCT

St. Paul Downtown Airport (STP), a level five VFR tower with radar, is a 100 percent NATCA facility with 13 controllers. The five most senior members at STP offer over 130 years of cumulative air traffic experience.

When the current tower was dedicated in 2000, the late Minnesota Congressman Jim Oberstar attended the ceremony. The facility is located within 10 miles of both Target Field, home of the Minnesota Twins, and TCF Bank Stadium, home of the Minnesota Vikings. The St. Paul Saints baseball team, a member of the American Association of Independent Professional Baseball, is building a new stadium less than two miles away.

"The people are definitely the best part of the FacRep job here," says FacRep Greta Potzmann. "STP members have a strong belief in NATCA and what it stands for."

CHAIRMAN OBERSTAR: NATCA CHAMPION AND TRUE SENTINEL OF SAFETY

Congressman Jim Oberstar was a tireless advocate for aviation, air traffic control, and NATCA during his tenure in Congress and as the Chairman of the House Transportation and Infrastructure Subcommittee. He routinely supported NATCA at Communicating for Safety (CFS) and NATCA in Washington (NiW).

It is profoundly sad that we were suddenly faced with saying goodbye to our dear friend on May 3, 2014, just a few weeks before the start of NiW. But as we sit here at our Biennial Convention in his home state, we continue to feel inspired by the Congressman's legacy and the great lessons he taught us about solidarity.

Just a few months after the Red Book took effect in 2009, NATCA invited Congressman Jim Oberstar to return to the NiW podium he already knew quite well. This time, NATCA had a special gift for him: a copy of the Red Book.



The Congressman was truly touched by the gesture. His remarks had always come from the heart, but on this day he shared deep emotions. Clutching the contract close to his chest, he spoke lovingly about growing up in Chisholm, Minn., the son of an iron miner.

He recounted how he was inspired by the activism of his father, who organized fellow miners to form a union to fight for safe workplaces and fair pay. His voice cracked when he told NATCAvists that giving him this contract was like giving him back a piece of his father.

NATCA also welcomed Congressman Oberstar to CFS 2011 where he addressed the membership during a luncheon.

"This is like homecoming. This is like a family reunion. Thank you so very much for a warm, warm welcome.

"Aviation doesn't work well if you don't have air traffic controllers. Every day you guide 2.5 million people in the airspace above us and you bring them safety and securely back to Earth. And there is no service sector, no economic sector, in any country that can compare with America's air traffic control system. None. You are the gold standard. And you know it. You're proud of it. And you say that every time you utter a command and issue an order to a flight deck."

"It's in your hands. Good hands. Great hands. Great minds. Great people. NATCA people."

Congressman Oberstar didn't just talk about unions or work with unions. He was Union. He understood our work ethic, our passion, our issues, our challenges, and our battles for fairness better than anyone. No matter what, he had the backs of every NATCA member. This is why NATCA is honored to announce the renaming of the Sentinel of Safety Award to the James L. Oberstar Sentinel of Safety Award.

Congressman Oberstar truly enjoyed his time with NATCA members and dedicated his career to the advancement of the National Airspace System. Today, we welcome the late Congressman's wife, Jean, to our Convention to celebrate and honor his commitment to NATCA.



DUES PANEL EXPLORES, ADVOCATES REVISED DUES STRUCTURE

Before Wednesday's roll call vote to fix the issue, Southern Regional Vice President Victor Santore called the problem of dues destabilization a "ticking time bomb" for the membership, straight out of what he recalled from the famous Bugs Bunny cartoons.

"The fuse is lit," he said during a panel discussion he chaired, "and we're asking you to put it out."

NATCA's dues are currently tied to the pay band minimums. Executive Vice President Trish Gilbert outlined the numbers and emphasized that the Union can't increase its revenue if it can't adjust the pay bands. The dues proposal coming before the convention body this week, she said, "is not to bring more revenue into the union coffers, it is to stabilize what we have now."

Southwest Regional Vice President Tim Smith said he and the rest of the Dues Workgroup members began their work in earnest in July 2012. They looked at other unions and crunched many numbers.

"This comes down to what kind of union you want," Smith said. "The last thing

I want to see is this Union become less of a union."

National Validation Team member and panelist Eddie DeLisle (Portland TRACON) made an impassioned plea for the restructuring, using the example of his own substantial pay raises made possible by NATCA, not the Agency or local management.

"They didn't give you raises because they liked you," he said. "It was the Union."

Gilbert closed her remarks by saying, "We believe it is well worth the change, to keep the Union as strong as it is today but also stronger in the future for our next generation to deal with all of these challenges that we have."



Dues panel participants: Eddie DeLisle, Ed Szczuka, Tim Smith, Mike MacDonald, Eugene Freedman, Trish Gilbert, and Victor Santore.

FOUNDATIONS OF PROFESSIONALISM

Earlier this year, NATCA and the FAA created “Foundations of Professionalism,” an umbrella term encompassing the collaborative programs that enhance and further the goal of the encouraging and maintaining the highest level of professionalism among the workforce.

Turn Off, Tune In



Professional standards teams at local facilities nationwide are leading the charge to educate their workforces about the consequences of distractions in transportation. This work has led to some innovative ideas.

At Chicago Center (ZAU), for example, NATCA FacRep Toby Hauck and Air Traffic Manager Bill Cound have set up a Turn Off, Tune In charging station. Dubbed “The Juice Bar,” the station reminds controllers that cell phone usage in the operational environment is distracting and dangerous.

“It is incumbent on all of us to keep our profession in high regard,” says Hauck. “Turn Off, Tune In is just one of the many ways for controllers to continue to promote our professionalism and pride we have for our job.”

While attending Communicating for Safety 2013, Charlotte (CLT) FacRep Anthony Schifano was inspired by the multiple charging stations available to attendees. CLT now has stations installed outside the operational areas.

“It has really been great,” Schifano says. He added that the stations are a subtle yet effective way of reminding employees not to take personal electronic devices into the operations rooms.

Other facilities making strides in distractions education include Baltimore Tower (BWI), Spokane Tower and TRACON (GEG), and Los Angeles Center (ZLA).



RINALDI, CONTINUED FROM PAGE 1

the NAS that controllers so deftly protect, day in and day out. “We have so many challenges and so much uncertainty ahead of us – FAA reauthorization, sequestration,” Rinaldi reminded the convention body. “The aviation system is on an unsustainable course. The funding mechanism is broken. What does the Senate look like? The House? The White House in ’16? Why sit idle? Why be reactionary? Let’s build the road to greatness. It starts today in Minneapolis.”

The top three issues facing the convention body, Rinaldi stated, are dues restructuring, decreasing convention frequency from two years to three, and participation in conversations regarding alternative funding and striking the word privatization from the NATCA constitution.

Regarding the dues restructuring vote, Rinaldi deferred to the panel following his speech to delve into the details, but he urged the delegates to think of the financial health of the Union. “We must stabilize our dues structure,” he said. “The question is, what kind of union do you want in the future? Every pocket in this room has been lined and padded because of what this great union has done for you.”

Dues income affects how the Union represents its membership and the quality of the events and programs it produces, including the nation’s premier

aviation safety conference, Communicating for Safety, and our biennial Convention. The NEB has submitted an amendment to the convention body to consider moving to a three-year cycle to save money and increase efficiency, as proposed changes to the NATCA Constitution and Bylaws have diminished greatly in the past decade.

In terms of the future of the NAS and the political and fiscal uncertainty in Washington, Rinaldi commented, “I don’t know where we’re going with this restructuring. But I do know that if we have the right people ask the right questions, engage in vigorous debate, we will move from good to great. We can sit on the side and let the show horses be in charge and create our future, but you will have a mess on your hands. Trish and I have said it before, if you’re not at the table, you’re on the menu.”

In closing, President Rinaldi thanked the attendees for traveling to Minneapolis to engage in the conversations that shape NATCA, today and in the future. “You are NATCA’s supreme body, and you are here to dictate the course our Union charts for years to come. You will speak your mind, have vigorous debate and set the course for the future. Move us from good to great! I’m all in. Are you?”

PHIL BARBARELLO, 2014 KRASNER AWARD RECIPIENT



“While others may slow down as their career winds down, [Phil] does not. That fire that started burning so many years ago will continue to burn bright till his last breath. That’s just who he is. If I took a poll and asked those of you to stand that he’s helped, that he’s provided counsel, advice, inspiration, motivation, kissed on the lips, bought a drink or has been welcomed with a hearty BRUTHA! So, let’s get to it. I’m honored and privileged to present the 2014 Krasner Award to my mentor, my friend and my BRUTHA: Phil Barbarello!” — Dean Iacopelli, N90, Eastern Region ARVP

FACILITIES CELEBRATE 100% NATCA MEMBERSHIP

The NATCA Difference campaign, the 16-week finale of “the year of organizing,” encouraged current members to open up lines of communication between members and non-members at facilities across the nation. Below you will find a list of every facility in the country that has achieved the ultimate in NATCA organizing: 100 percent union membership. This impressive achievement is the culmination of hard work, solidarity and unwavering commitment to NATCA. Congratulations!



ALASKAN REGION

Fairbanks ATCT (FAI)
FS4Flight Services (NAATS) - PAQ
Juneau ATCT (JNU)

CENTRAL REGION

Omaha/Eppley ATCT (OMA)
Spirit of St. Louis ATCT (SUS)
Sioux City ATCT (SUX)
St. Louis TRACON (T75)

EASTERN REGION

Wilkes Barre ATCT (AVP)
Buffalo ATCT (BUF)
Baltimore Washington ATCT (BWI)
Caldwell ATCT (CDW)
Newark ATCT (EWR)
Farmingdale ATCT (FRG)
Manassas ATCT (HEF)
Huntington ATCT (HTS)
Ithaca ATCT (ITH)
Morristown ATCT (MMU)
Newport News ATCT (PHF)
North Philadelphia ATCT (PNE)
Poughkeepsie/Dutchess County ATCT (POU)
Roanoke ATCT (ROA)
Teterboro ATCT (TEB)

GREAT LAKES REGION

Ann Arbor ATCT (ARB)
East St. Louis BI State Parks ATC (CPS)
Chicago/DuPage ATCT (DPA)
Kenosha ATCT (ENW)
Flying Cloud (Minneapolis) ATCT (FCM)
Terre Haute ATCT (HUF)
Lafayette/Purdue University ATCT (LAF)
Mansfield ATCT (MFD)
Minneapolis Crystal ATCT (MIC)
Madison ATCT (MSN)
Marion ATCT (MWA)

Pontiac ATCT (PTK)
Rochester ATCT (RST)
Springfield Capital ATCT (SPI)
St. Paul ATCT (STP)
Traverse City ATCT (TVC)

NEW ENGLAND REGION

Bradley International ATCT (BDL)
Bedford ATCT (BED)
Bangor ATCT (BGR)
Portland (Maine) ATCT (PWM)

NORTHWEST MOUNTAIN REGION

Broomfield Jefferson County ATCT (BJC)
Boise ATCT (BOI)
Eugene ATCT (EUG)
Spokane ATCT (GEG)
Great Falls ATCT (GTF)
Helena ATCT (HLN)
Moses Lake/Grant County ATCT (MWH)
Everett Paine Field ATCT (PAE)
Pueblo ATCT (PUB)

SOUTHERN REGION

Albany ATCT (ABY)
Mobile Downtown ATCT (BFM)
Cherry Point DoD (NKT)
Columbus (GA) ATCT (CSG)
Fort Lauderdale Executive ATCT (FXE)
Wilmington New Hanover Co. ATCT (ILM)
Miami Tower/TRACON (MIA)
Montgomery/Dannelly Field ATCT (MGM)
Melbourne ATCT (MLB)
Opa-locka FCT (OPF)
Orlando Executive ATCT (ORL)
Owensboro Daviess ATCT (OWB)
West Palm Beach ATCT (PBI)
St. Petersburg/Clearwater ATCT (PIE)
Pompano Beach FCT (PMP)

Pensacola ATCT (PNS)
Sanford ATCT (SFB)
San Juan ATCT (SJU)
St. Thomas/Truman ATCT (STT)
Tuscaloosa ATCT (TCL)
Tampa ATCT (TPA)
Bristol Tri City ATCT (TRI)

SOUTHWEST REGION

Amarillo ATCT (AMA)
Beaumont Port Arthur ATCT (BPT)
Ft. Worth Spinks ATCT (FWS)
Georgetown ATCT (GTU)
McKinney ATCT (TKI)
Rogers ATCT (ROG)
Roswell ATCT (ROW)
San Marcos ATCT (HYI)
Santa Fe ATCT (SAF)
Sugarland ATCT (SGR)

WESTERN PACIFIC REGION

Bakersfield Meadows Field ATCT (BFL)
Burbank ATCT (BUR)
Concord (CA) ATCT (CCR)
Camarillo ATCT (CMA)
Chino ATCT (CNO)
Carlsbad Palomar ATCT (CRQ)
Falcon/Mesa ATCT (FFZ)
Grand Canyon ATCT (GCN)
Hayward ATCT (HWD)
Kalaeloa DoD (JRF)
McCarran ATCT (LAS)
San Diego Montgomery ATCT (MYF)
Palo Alto ATCT (PAO)
Scottsdale ATCT (SDL)
Santa Rosa/Sonoma County ATCT (STS)

NATCA CHARITABLE FOUNDATION

SILENT AUCTION: FEATURED ITEMS OF THE DAY

All proceeds from the NCF Silent Auction benefit area charities like the ones featured every day in The Delegate. Bid often and bid high! It is for charity after all!



**Kenny Chesney
Autographed Guitar**
Donated by Kenny Chesney

CURRENT HIGH BID: \$250

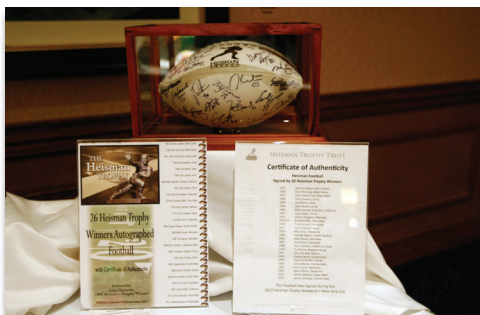

**26 Heisman Trophy Winners
Autographed Football**
Donated by Gino Torretta, 1992
Heisman Trophy winner

CURRENT HIGH BID: \$400

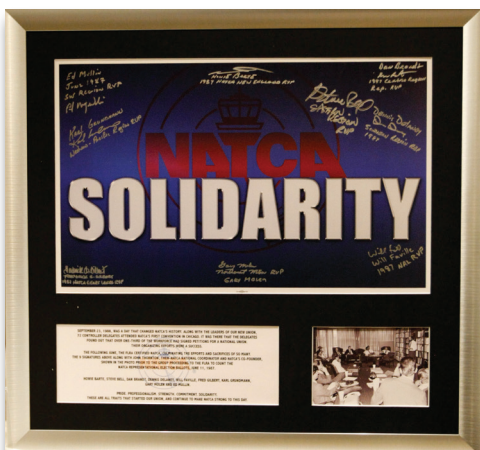

History In Solidarity Poster

Signatures of the nine original regional representatives who observed the ballot count to form the National Air Traffic Controllers Association. Donated by Elena Nash and NATCA National Office.

CURRENT HIGH BID: \$125

CHARITY SPOTLIGHT

Volunteers of America – Minnesota

voamn.org



Volunteers of America – Minnesota helps people gain self-reliance, dignity, and hope through charitable programs that improve health and human services in the state of Minnesota. As one of the state's oldest and largest charitable organizations, Volunteers of America – Minnesota has been helping people for over 117 years. The organization focuses on seniors and people with special needs, children, youth and families, and rehabilitative and veterans services.

The organization boasts strong stewardship, finishing fiscal year 2013 with a surplus of \$167,101, a 17 percent increase of charitable support, and a renewal of funding from governmental agencies such as the Dept. of Housing and Urban Development.

Dorothy Day Center

cctwincities.org/DorothyDayCenter



The Dorothy Day Center is a resource center and shelter program that provides meals, mental health services, medical care, and much more to help people suffering from homelessness. After dinner is served seven days a week, the building is transformed into an emergency shelter with space for 200 people. The center also runs a women's shelter that provides temporary housing to 42 single women. The women are offered counseling, education and training, and recreational activities.

Initial funding has been secured for *Dorothy Day ReVision*, a two phase, two building, \$65 million project which will include increased affordable housing, dignified shelter space, and a connection center. This ReVision will be realized in the heart of downtown Saint Paul in close proximity to the existing Dorothy Day Center.

NCF 5(K) FUN RUN

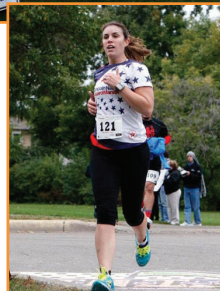
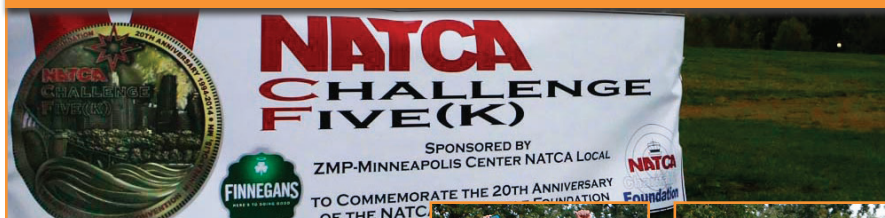

A brisk 52 degrees didn't keep our participants away from the first ever NATCA Charitable 5(K). Proceeds from the race will benefit the local charities featured in The Delegate each day. Thank you and congratulations to all our participants! And, as always, this could not have been possible without the help of volunteers. Thank you, volunteers! The winners are:

Men's division

- 1st: James Mack (RFD)
- 2nd: Curt Fischer (A90)
- 3rd: Nick Cassano (PVD)

Women's division

- 1st: Jenny Benjamin (LNK)
- 2nd: Amanda Stierwalt (ICT)
- 3rd: Monika Brandt (M98)

Team division

NATCA NLC: Jason Arnold (ZME), Jenny Benjamin (LNK), Trisha Pesiri-Dybvik (SBA), Corey Soignet (ZFW), Denise Spencer (ZSE), Steve Weidner (ZMP)

Dr. Ruth Stilwell (ZMA) raised the most money (\$1,000) for NCF.

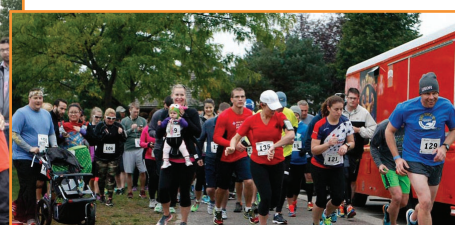

ZAU, CONTINUED FROM PAGE 4

and ingenuity that has been demonstrated over the past three days is truly astounding.”

Controllers at ZAU were understandably shaken by the events, which are currently under investigation by the FBI. “The controllers at Chicago Center are currently providing as much assistance to other facilities as possible,” NATCA FacRep Toby Hauck said. “I have attempted to put into words what we have been through, and it is impossible to describe. I thank all those facilities and controllers who have stepped up.”

Controllers at the affected facilities are still working to mitigate the costly incident. While delays have been steadily decreasing throughout this week, it’s been a challenge to handle the thousands of flights that ZAU normally directs.

“We continue to work hard, and I am so proud of the controllers’ professionalism and work ethic,” Chicago TRACON (C90) FacRep James Hall said. “We are C90 – we will always figure out a way to move the airplanes. I anticipate increasing our efficiencies with continued out-of-the-box thinking. That is, of course, with continued ZAU controller support, and staffing to hold.”

Here in Minneapolis, controllers at ZMP have been working diligently to take on added workload. “We

have extra staffing in the facility to help with the situation,” FacRep Mike Thompson said. “There are many great people doing many great things with very little to work with.”

Controllers working radar positions at the TRACONS in Cedar Rapids, Champaign, Des Moines, Fort Wayne, Grand Rapids, Kalamazoo, Madison, Milwaukee, Moline, Muskegon, Peoria, Rockford, South Bend, Springfield, Waterloo, and also Grissom Air Reserve Base in Kokomo, Ind., have played a crucial role in the effort to get traffic moving as a temporary solution while ZAU is down. In the case of traffic flowing into and out of Chicago airports, they are providing a conduit between the adjacent centers and Chicago TRACON.

“These employees are working a staggering amount of traffic, using new procedures and methods being altered almost constantly, and ensuring safety in very difficult and pressure-filled situations,” Gilbert said. “It’s a great team effort in progress.”

Bryan Zilonis NGL RVP:

“NATCA air traffic controllers have once again established that when an emergency occurs, our nation’s skies will always remain safe. Whether it is clearing the NAS of thousands of flights safely, or recreating Chicago Center traffic flows in surrounding facilities to keep America flying, they have always delivered. I could not be more proud to represent these people.”

Jeff Richards NGL ARVP and former ZAU FacRep:

“As history has shown, the controllers at all our facilities have rolled up their collective sleeves and pitched in to restore our nation’s air traffic control system. The teamwork shown by our controllers during this event has been incredible. All the facilities surrounding Chicago Center deserve the utmost respect for the herculean work they are doing restoring the Chicago area airports to as close to normal as possible.”



Open a Local Account with SkyOne
No monthly fees, no balance requirements

SkyOne has helped 145 Fac Reps manage their local accounts with ease and convenience. Let us help you manage yours today.

Why Choose SkyOne?

- No monthly maintenance fees
- No monthly service fees
- No minimum balance requirements
- Easy to switch the signer on the account
- A dedicated representative managing your account

**Visit Us at the
SkyOne Booth**



Your savings federally insured to at least \$250,000 and backed by the full faith and credit of the United States Government

SkyOne.org | 800.421.7111

SkyOne
FEDERAL CREDIT UNION
Proud sponsor of NATCA

REGIONAL ROUNDUP



ALASKAN REGION

Scot Morrison has settled in as the new RVP after having taken over in July from **Steve Munroe**, who retired. Morrison saluted Munroe's years of NATCAvism, which included his great service as a member of the Red Book negotiating team. "The NATCA members in the Alaskan Region have been great welcoming me and allowing me to share my experience with them," Morrison said. →→ Anchorage Center's (ZAN) **Jennie Sandland** and Anchorage Tower's **Kaui Hayden** have led NATCA's efforts on a joint program with the FAA called the Collaborative Outreach Program. The goal is to increase communication between controllers and pilots and to provide public education to improve flight safety. The program includes booths at fly-ins, trade shows, safety seminars, and symposiums. They have briefed nearly 1,000 air carrier and air taxi pilots in Alaska thus far. "We have received tremendous support and appreciation from each and every operator that we have worked with," Sandland says. "Pilots are very interested in knowing how their actions impact controllers." →→ The new Flight Service Station (FSS) National Rep is **Dean Miller**, who took over for **Tom Elmer** on Sept. 1. NATCA represents four hub FSS facilities with another 13 outlying facilities.



CENTRAL REGION

The death of former RVP (2000-2006) **John Tune** on July 23 at the age of 58 was a profoundly sad and tragic loss for Kansas City Center (ZKC), the region, and the membership nationwide. "John was a mentor to me while I was the FacRep at MCI," RVP **Kevin Peterson** says. "After I became RVP, I often looked to John for counsel. John was a true friend and he had a deep concern for worker rights, which he continued fighting for every day of his life." ZKC held its annual golf tournament in August and renamed it the ZKC NATCA John Tune Memorial Golf Tournament. The tourney raised over \$1,500 (pictured) for KidsTLC, an organization based in Olathe, Kan. →→ Collaboration is going well at Kansas City Tower (MCI). "I'd say the best part of being FacRep here is being able to play a major role in the new relationship that is being built between NATCA and management," says FacRep **Matt Williams**. "We have people on both sides who see the importance of moving forward together." →→ Congratulations to St. Louis TRACON's (T75) **Mark Schad**, winner of the Air Traffic Control Association's (ATCA) Andy Pitas Memorial Award for an outstanding flight assist.



EASTERN REGION

Allentown (ABE) is thrilled to be the first STARS Elite facility. "I'm really proud of our facility and the effort our entire building put into this transition," ABE FacRep **Shannon Shuey** says. "We are so excited to receive this equipment, and we look forward to all the opportunities it will afford us." →→ DataComm testing at Newark (EWR) is going well. "As I've gone through the project and learned more about it and seen it from the industry and the pilots' side, and the benefit to them, it even exceeded my expectations of the benefits," EWR FacRep **Ray Adams** says. →→ **Chris Wells**, who is approaching his one-year anniversary as Norfolk FacRep, is the grandson of two trade unionists who he says instilled a "great work ethic and dedication to their fellow employees." He says, "The most rewarding part of being the facility president is the feeling of satisfaction in helping the collective and the camaraderie that comes with it." →→ Northeast Philadelphia Airport members celebrated NATCA's 27th anniversary with a special NATCA cake. Pictured from left to right: **Joshua Tavares**, **Kawain Powell**, **Michelle Fernandez**, **Zaheerah Zimmerman**, and **Kevin Fennel** holding **Elías**, Fernandez's son.



GREAT LAKES REGION

Detroit-area members have stepped up their solidarity. One summer highlight included a large gathering at a Detroit Tigers game that also included members from Toledo (who, later in the summer, held a big annual solidarity event of their own at a minor league Mud Hens game). Prior to the Tigers game, the members received a legislative briefing that included remarks from former President **John Carr**. →→ **Judd Wallace** (Cleveland Center) is a third-generation union member. His father has been a member of a union as a power plant operator for over 30 years, and his grandfather worked as a union machinist for over 40 years in a steel mill. Wallace's advice to members looking to get involved? "Don't be intimidated; getting involved is easier than it seems. There are countless opportunities to become involved in our Union." →→ Members of Minneapolis Center's (ZMP) service review team received an FAA Safety Vanguard award in recognition of their accomplishments as reviewers of the facility's quality of ATC services. The team includes five NATCA safety team participants. "I think it's a great thing and a great tool," says member **Reid Beucher**. "People now realize the safety issues. I think there's a lot of value to it."



NEW ENGLAND REGION

Nunzio DiMillo (Boston Tower), a 23-year veteran member, added a third award this week in honor of last year's great flight assist when he prevented a Cirrus SR22 from landing on an occupied taxiway instead of the runway. Already this year's regional Archie League Medal of Safety Award winner and President's Award winner, DiMillo also won the ATCA Andy Pitas Memorial Award. →→ Thanks to the leadership of Regional Legislative Rep **Jay Bowers**, several facilities have hosted visits from Members of Congress this year. The latest, earlier this month, was at Manchester Tower, where Congresswoman Carol Shea-Porter met with members and airport officials. "I rest comfortably every time I fly knowing NATCA controllers are on the job," she said. →→ Portland, Maine, FacRep **Jeff Breault** says his 100 percent NATCA facility has a great atmosphere. "The best part of being FacRep is being able to help shape the future of the facility, and try to provide the best working conditions for my fellow members," he says. →→ Congratulations **Mike Odryna** (ZBW) on 10 years as Chairman of the OSHA Committee!

REGIONAL ROUNDUP



NORTHWEST MOUNTAIN REGION

Outgoing Salt Lake City Center (ZLC) FacRep **Will Kramer's** leadership has set the local on a path to greater membership numbers, says incoming FacRep **Joel Brown**. "He wanted to emphasize the fact that we are a professional organization representing professional employees in an incredibly important and professional career. Will's vision was for our local to get a foot in the door of every meeting in the building." →→ Seattle Tower's (SEA) **Sam Navarro**, now in her third year as FacRep, says her best advice for members who would like to get involved is, "don't wait for someone to come to you. Find your niche and run with it. It makes us stronger as a whole if we have people doing what they love." →→ Just 16 days after the first live operational test of STARS as a replacement for the aging CARTS 3E system at Denver TRACON (D01), the facility achieved continuous operations status on Sept. 10. D01 TAMR Rep **Brian Reddy** was instrumental in ensuring the training for D01 was developed and conducted properly. →→ The best part about being FacRep at Aspen? It's the atmosphere, says **Laura Smith**. "It's so wonderful coming to work and knowing that we can all work together to make the best out of each day."



SOUTHERN REGION

Miami Center (ZMA) presented the FAA Vanguard of Safety Award earlier this month to member **Jeff Wartens**, honoring the work and deep commitment of a safety professional who helped lead the facility's successful efforts to implement voluntary skill enhancement training by keeping the focus on the operation and away from bureaucracy. →→ Congratulations **Kevin Oswald** (Kissimmee FCT), winner of the ATCA Air Traffic Control Specialist of the Year Award, presented earlier this week! →→ On Sept. 10, Jacksonville Center (ZJX) declared IOC, the latest in a series of ERAM successes in the region. ZMA declared ORD on Aug. 1, and Atlanta Center (ZTL) reached IOC in July. ZTL FacRep **Rick Baugh** praises the work of the facility's ERAM team that, he says, "did a fantastic job preparing, testing, and getting us to IOC." →→ New equipment is regularly tested at Louisville-Standiford (SDF), as well as the new wake turbulence RECAT rules allowing reduced separation between certain aircraft. "The atmosphere in our facility is a team effort to provide the best service we can to our customers. We all strive to help each other and look out for one another," SDF FacRep **Mark Varady** says.



SOUTHWEST REGION

Austin (AUS) members **Matt Sheffield** and **Kristen Lewandowski** (who has since transferred to Portland TRACON) were honored this week by ATCA. They won the Andy Pitas Memorial Award for their great flight assist earlier this year. →→ Houston Center (ZHU) FacRep **Andrew LeBovidge** calls the Houston OAPM procedures "the culmination of approximately two years of intense collaborative efforts by dedicated representatives from NATCA, the FAA, and industry. The controllers handled this dramatic change in procedures with their typical aplomb and cool professionalism." Adds **Steven Prichard** (Houston TRACON), who volunteered for the Metroplex team, "It was a lot more in-depth and challenging than I thought it was going to be. But that also made it enjoyable." The OAPM team then moved up to the Dallas-Fort Worth Metroplex, where procedures are currently being implemented. Look for coverage soon in the NATCA Insider. →→ ARVP **Ric Loewen** (DFW) is nearing his 25th anniversary. From the very start, he says, "I saw the value of a strong union protecting employees' rights and fighting to improve our working conditions. Clearly my peers cared more about my success than my employer did."



WESTERN PACIFIC REGION

James "JC" Cain worked at Monterey, Calif., Tower (MRY) for 20 of his 25-year FAA career. He was a NATCA member for that time as well. His MRY brothers and sisters, led by FacRep **Kendall Scott**, gave him a memorable retirement sendoff on the beach (pictured),



presenting him with a watch and a plaque that read, "In gratitude for your unwavering standards of excellence." →→ A new San Francisco Tower (SFO) is rising above the airport. Its completion will come none too soon for SFO members **Rob Shelton** and **Fred Naujoks**, who were working the mid on Aug. 24 when the Napa earthquake shook the tower. "The whole building sounded like it was cracking and creaking," Naujoks says. Over at Oakland, FacRep **Juan Serna-Spuler** was working the mid but realized the "rollers" on which the new tower was built had done their job and absorbed the impact. Meanwhile, Napa controllers continue to work out of a temporary trailer while damage to their tower is repaired. →→ Phoenix TRACON's (P50) **Aaron Katz**, on the most rewarding part of being FacRep: "Always fighting the good fight and standing up for those who can't or simply don't know how to go about it is very rewarding."



REGION X

NATCA and the FAA have implemented the Airport Voluntary Reporting System (AVRS) that allows Airports BUEs to elevate safety concerns to Agency headquarters without fear of retaliation. The Airports office offered a similar program to the airport certification safety inspector workforce several years ago. "It is nice to share the Office of Airports' vision for a safety reporting system that is collaborative and will directly and comprehensively address the safety concerns of both FAA and NATCA," says Regional Vice President **Mike MacDonald**. "Removing the fear of retaliation is an important step forward." →→ One of the many positive things about the recent open season and The NATCA Difference campaign was putting a spotlight on the great safety professionals we represent. One example: Atlanta-based Logistics Management Specialist **Tisa Barnett** (pictured). She has Master of Business Administration and Master of Human Resource Management degrees. She was featured in our "I am a professional, I am Union, I am NATCA" poster series. →→ AIR-100 Member **Anthony Vilante**, on why it is important that NATCA represents him and his fellow bargaining unit members: "Strength in numbers. Unionized professionals have more power as a cohesive group than as individuals. What you gain is the muscle of collective action."



CONVENTION IN PHOTOS

OPENING RECEPTION: BRIT'S PUB



#MYLABORTEE

NATCA MEMBERS SHOW OFF THEIR FAVORITE LABOR SHIRT

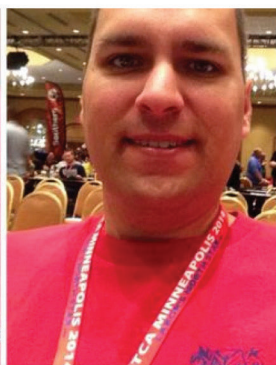

In Solidarity

Associate Members

Past and Current

Raymond Andrae, Jr.

Grant Anderson

James Apone

Donald Bagley

Phil Barbarello

Luke Ball

Michael Bates

Rick Baugh

Betsy Beaumont

David Bennett

Bill Blackmer

Mike Blake

Jeff Blow

Craig Boehne

Carol Branaman

Kenneth Burton

Andrew Cantwell

Ronald Carpenter

Eric Carter

Timothy Casten

Don Chapman

Scott Conde

Brandan Connolly

Dave Cook

William Crowson

Robert D'Addario

James D'Agati

Daniel D'Agostino

Tomaso DiPaolo

Kurt Earth

Will Faville

Jeffrey Fisher

Patrick Forrey

Drew Frankel

Joe Fruscella

Ham Ghaffari

Trish Gilbert

Peter Girard

Patrick Gallagher

Jimmy Garrett

Selma Golding-Forrester

Ken Greenwood

Mark Griffin

Eric Grundmann

Elizabeth Hackbart

Kelvin Hale

David Hastings

Douglas Hintz

Daniel Horwitz

Curt Howe

Mike Hull

Renae Hultgren

Dean Iacopelli

Jeff Kanter

Scott Kelley

Steven Kelley

Todd Kerekes

Barry Krasner

Douglas Laughter

Andrew LeBovidge

Larry Lescanec

Andrew Lewis

Bill Liberty

Richard Loewen

Michael MacDonald

Kevin Maney

James Marinitti

Robert Marks

Ruth Marlin

Kenneth Martin

Marilyn Martin

Bill McGowan

Michael McNally

Darrell Meachum

Ed Mears

Scott Morrison

Ron Murray

Gerry Nash

Nicole Paider

Todd Parker

Kevin Peterson

George Petrovich

Douglas Pincock

Elaine Poe

Timothy Poer

Stephen Ramsden

Michael Redmond

Bernie Reed

Glen Rice

Dave Riley

Paul Rinaldi

Edward Rivas

Mike Robicheau

Victor Santore

Patrick Shanahan

Tim Smith

Vince Sugent

Edward Szczuka

Rocco Taggio

Robert Taylor

Rick Thompson

Troy Thompson

Sandra Tighe

Joe Trainor

Bradley Troy

John Tune

Rodney Turner

Jim Ullmann

Donald Vincelette

Steven Wallace

Jeff Walukonis

Jeffrey Wonser

Dale Wright

Joe Yannone

Thomas Zaccheo

Bryan Zilonis

Please contact [Melinda Kim](#), [Damien Maree](#), [Kendal Manson](#), [Cecilia Harley](#) or [Mickela Gillfillan](#) for information on joining ONEU as an Associate Member.

CONVENTION WORKSHOPS

4 Key Components to Building a Stronger Local

Facilities < 50 Members • Thursday, October 2 • 12:25 - 1:25 p.m. • Marquette VIII & IX

Locals are the foundation of our Union. Having a basic understanding of four key components (communication, education, solidarity and involvement/activism) and the dynamics within your local, along with personal involvement, are the first steps to building a stronger local and a more powerful NATCA.

Arrested Development: Off-Duty Incidents

Thursday, October 2 • 12:25 - 1:25 p.m. • Conrad A

Learn what happens when you have an off-duty incident that includes drugs or alcohol (DUI, DWI, Public Intoxication). We concentrate on the process and how it affects you.

Communications and Social Media

Thursday, October 2 • 12:25 - 1:25 p.m. • Marquette VI

Friday, October 3 • 7:30 - 8:20 a.m. • Marquette III

Participants will learn about best practices in the use of social media for effective communications, as well as practices that should be avoided, particularly for NATCA members and federal employees.

Key NATCA Arbitrations (Part II) & Witness Selection/Preparation

Thursday, October 2 • 12:25 - 1:25 p.m. • Marquette VII

After an arbitration skills primer, you are surely ready to test your advocacy skills, right? Join us for an interactive exercise, and try your hand at being an advocate.

Local Union Officer Elections 101

Friday, October 3 • 7:30 - 8:20 a.m. • Marquette VIII & IX

This course is designed to help educate local union officials on how to properly plan and conduct local officer elections. Participants will learn what to do (and what not to do) before, during, and after a local election to ensure compliance with the Labor-Management Reporting and Disclosure Act (LMRDA).

Local Organizing

Friday, October 3 • 7:30 - 8:20 a.m. • Marquette II

Organizing is not "other duties as assigned." Organizing is organizational and must be an integral part of everything we do. This class will provide you with the tools and resources to grow our Union at the local level.

NATCA Safety

Thursday, October 2 • 12:25 - 1:25 p.m. • Symphony I & II

This course is designed to provide NATCA FacReps, Area Reps, Facility Safety Reps, and safety activists with an understanding of how to utilize various safety tools to ensure a safe operating environment for the flying public. This course will provide an overview of ATSAP and Event Reporting, Safety Management System (SMS), Quality Control/Quality Assurance processes, and Partnership for Safety (PFS).

OSHA Awareness

Thursday, October 2 • 12:25 - 1:25 p.m. • Conrad D

After this class, you will understand the strategies that will be implemented to maintain acceptable Indoor Air Quality (IAQ) in the workplace. Topics include: chemicals that affect IAQ, water intrusion and mold growth inside buildings, temperature and humidity, and sick building syndrome, etc.

PAC Advocacy

Friday, October 3 • 7:30 - 8:20 a.m. • Marquette IV

The PAC Advocacy class is geared toward the activist who wants to learn how to advocate for the PAC and discuss the PAC with their fellow members. In this class, activists will learn about many of the myths surrounding the NATCA PAC. We will discuss successes that NATCA has enjoyed over the years and how the PAC relates to those successes. This class isn't a PAC pitch, but rather an educational session on how to effectively discuss and advocate for NATCA.

Presenting Greatness

Thursday, October 2 • 12:25 - 1:25 p.m. • Duluth Room

This course is designed to give public speakers more confidence and organization to pave the way for better retention on the part of their listeners. The seminar covers the following: conquering nervousness, the five-part formula for organizing presentations, dealing with challenging attendees, and various tips and techniques from a professional speaker.

Your Traffic, Your Complexity, Your Pay

Thursday, October 2 • 12:25 - 1:25 p.m. • Marquette II & III

Topics include: the history and governing documents of the National Validation Team, formula and variables for calculating Traffic Complexity Index (TCI) and the role of the TCI in pay setting, and why and how you should become proactive at your facility with regards to traffic counting.

Thales is proud to partner with NATCA for today's ATC technology... and tomorrow's



Thales is honored to work with NATCA in developing critical air traffic control technology. Together, we have successfully delivered data communications technology operational at more than 35 airports worldwide and now adapted specifically for clearance delivery applications in US towers.

Thales values the commitment NATCA shows to the safe, efficient management of airplanes across the country. NATCA's commitment has inspired us to continue to evolve our tower automation suite – used by more than 16,000 controllers worldwide – to help address the specific needs of the US controller. The Thales adaptable solution features Data Comm, Arrival and Departure management tools, electronic flight data management, and the ability to share information across each tower position from a single, integrated position to streamline operations and reduce workload.

Thales is partnering with controllers around the world to develop technology that helps with today's ever-increasing ATC demands, and tomorrow's. For more information, contact us at ATM@us.thalesgroup.com

THALES

NATCA TWEETWALL ALL STARS

 **Patrik Peters**
@Patriktwix

#NATCAMSP A great opening act! NATCA - you know how to unite & motivate! I'm all in!

 **David Riley**
@DaveRileyATC

Restructuring our NATCA dues system is vital to maintain the high level of professionalism of our Union! #NATCAMSP

 **Liz Shuler**
@lizshuler

.@NATCA members are amazing. They rise above the budget cuts & contract battles. Fighting for safety & professionalism #inspiring #NATCAMSP

 **Nick Daniels**
@Nick_D78

Honored to be here with all of our NATCA brothers and sisters!! ZFW is all in! #NATCAMSP #SOLIDARITY

 **Tony Yushinsky**
@yazoo68

"There is power in the Union!!" #NATCAMSP

Reply Retweet Favorite Storify More

 **Unable Records**
@UnableRecords

Awesome gathering of amazing union activists; proud to call myself a member of the National Air Traffic Controllers Association! #NATCAMSP

 **Bryan**
@bzlonis

#NATCAMSP

Minneapolis, MN

Reply Retweet Favorite Storify More



 **Sam Pono**
@sam1sf

"We need to take control of our destiny" Paul Rinaldi #NATCA President #NATCAMSP #allinformatca

Follow

 **Abigail Glenn-Chase**
@AGCinDC

Added one more to the NATCA family! #NATCAMSP

Reply Retweet Favorited Storify More



NOW ARRIVING...

THE NEXT GENERATION OF AIR TRAFFIC MANAGEMENT.

AT LOCKHEED MARTIN,
WE'RE ENGINEERING A BETTER TOMORROW.

The future of air traffic management is here. Air traffic and airport management technologies designed and built by Lockheed Martin facilitate thousands of journeys daily, helping billions of passengers arrive at their destinations safely and more efficiently than ever before.

For More Information visit lockheedmartin.com

© 2014 LOCKHEED MARTIN CORPORATION

LOCKHEED MARTIN 

CONVENTION EVENT INFORMATION

THURSDAY OCTOBER 2

Great Lakes Regional Dinner

Cowboy Jack's • 126 5th St. N • 6:00 p.m.

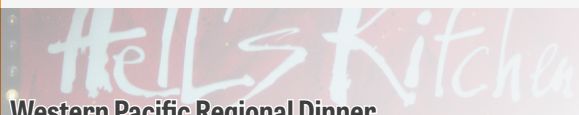

Western Pacific Regional Dinner

Hell's Kitchen • 80 S. 9th St. • 6:00 p.m.

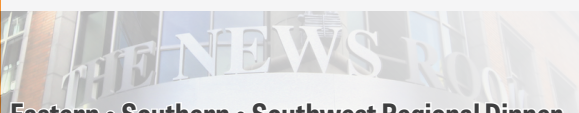
Alaskan • Central • New England • NW Mtn • Region X Regional Dinner
The Pourhouse • 10 South 5th St. • 6:00 p.m.

Eastern • Southern • Southwest Regional Dinner

The News Room • 990 Nicollet Mall • 6:00 p.m.

FRIDAY OCTOBER 3

Closing Banquet

Nicollet Island Pavilion

Wristband required for admission.

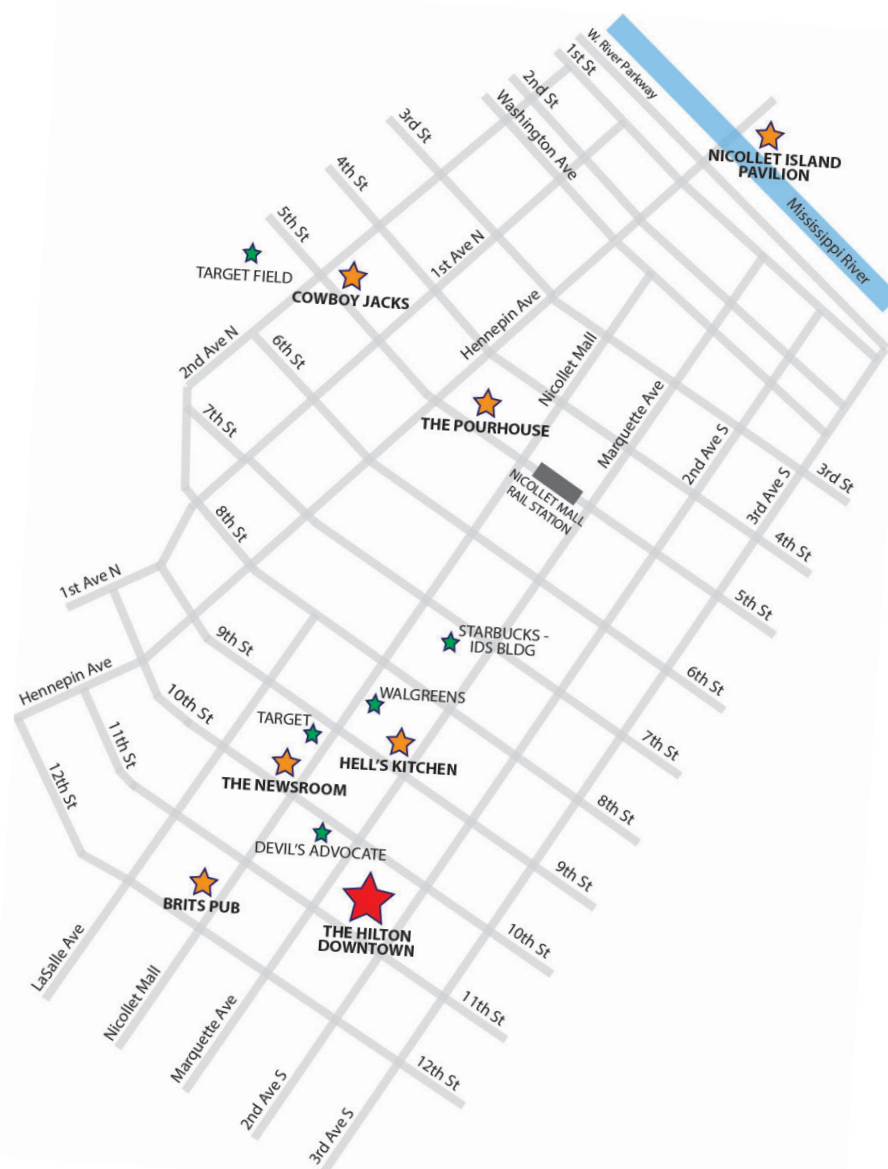

The Delegate

National Air Traffic Controllers Association
1325 Massachusetts Ave., N.W.
Washington, D.C. 20005
natca.org

Publishers

Paul Rinaldi, President
prinaldi@natcad.orgPatricia Gilbert,
Executive Vice President
tgilbert@natcad.org

Creative Director

Laura Roose
lroose@natcad.org

Managing Editor

Abigail Glenn-Chase
aglennchase@natcad.org

Director of Communications

Doug Church
dchurch@natcad.orgSenior Comm. & Public
Affairs AssociateSarah McCann
sdunn@natcad.org

Communications Specialist

Amy Treutel
atreutel@natcad.org

Contributing Writers

Grace Colby
gcolby@natcad.orgAnna Weidner
aweidner@natcad.org

Photographers

Doug Jones
George Petrovich

HILTON MINNEAPOLIS • 1001 S. MARQUETTE AVENUE

2ND FLOOR: CONRAD ROOMS

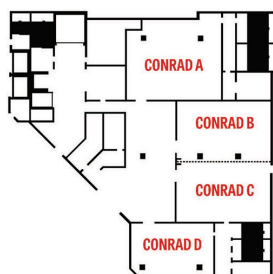

2ND FLOOR

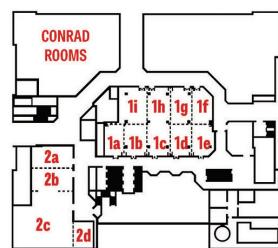

- 1a. Marquette I
- 1b. Marquette II
- 1c. Marquette III
- 1d. Marquette IV
- 1e. Marquette V
- 1f. Marquette VI
- 1g. Marquette VII
- 1h. Marquette VIII
- 1i. Marquette IX
- 2a. Symphony I
- 2b. Symphony II
- 2c. Symphony III
- 2d. Symphony IV

3RD FLOOR



- 1. Rochester
- 2. Board Room 1
- 3. Board Room 2
- 4. Board Room 3
- 5. Director's Row 1
- 6. Red Wing Room
- 7. Director's Row 2
- 8. Director's Row 3
- 9. Director's Row 4

2014 CONVENTION APP



iPHONE



iPAD



ANDROID